

# *The 9500 Series Family*

*Series 9502 & 9503*

*Thermally Broken Aluminum Outswing Balcony Door*

**STARLINE  
WINDOWS**



*Standard  
Details*

*Quality, Comfort & Peace of Mind*

# STARLINE WINDOWS

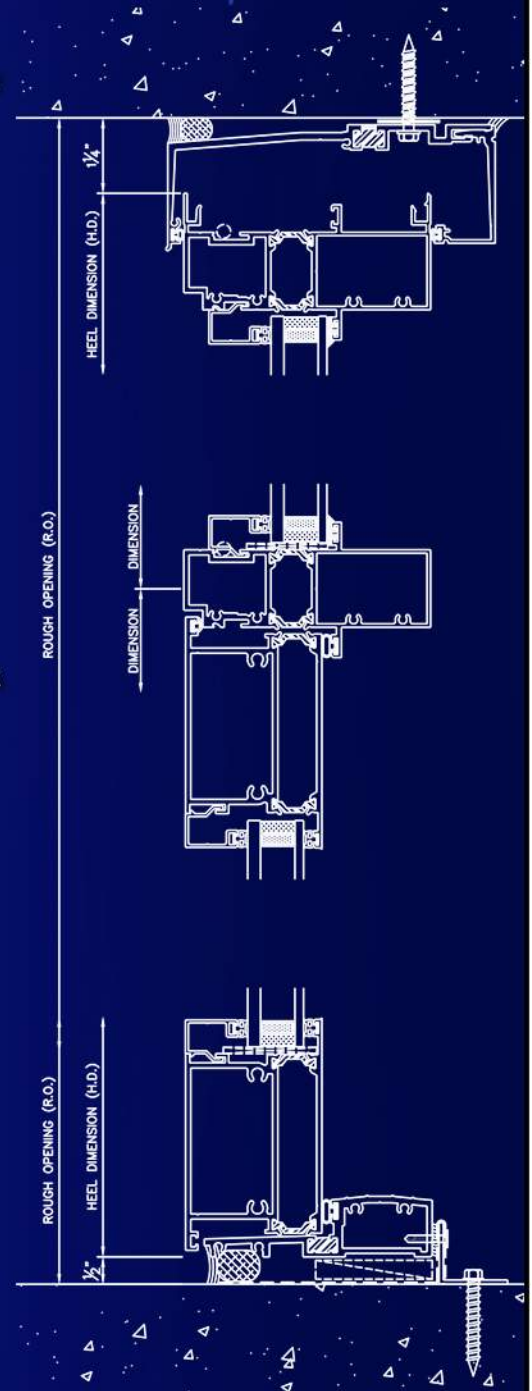
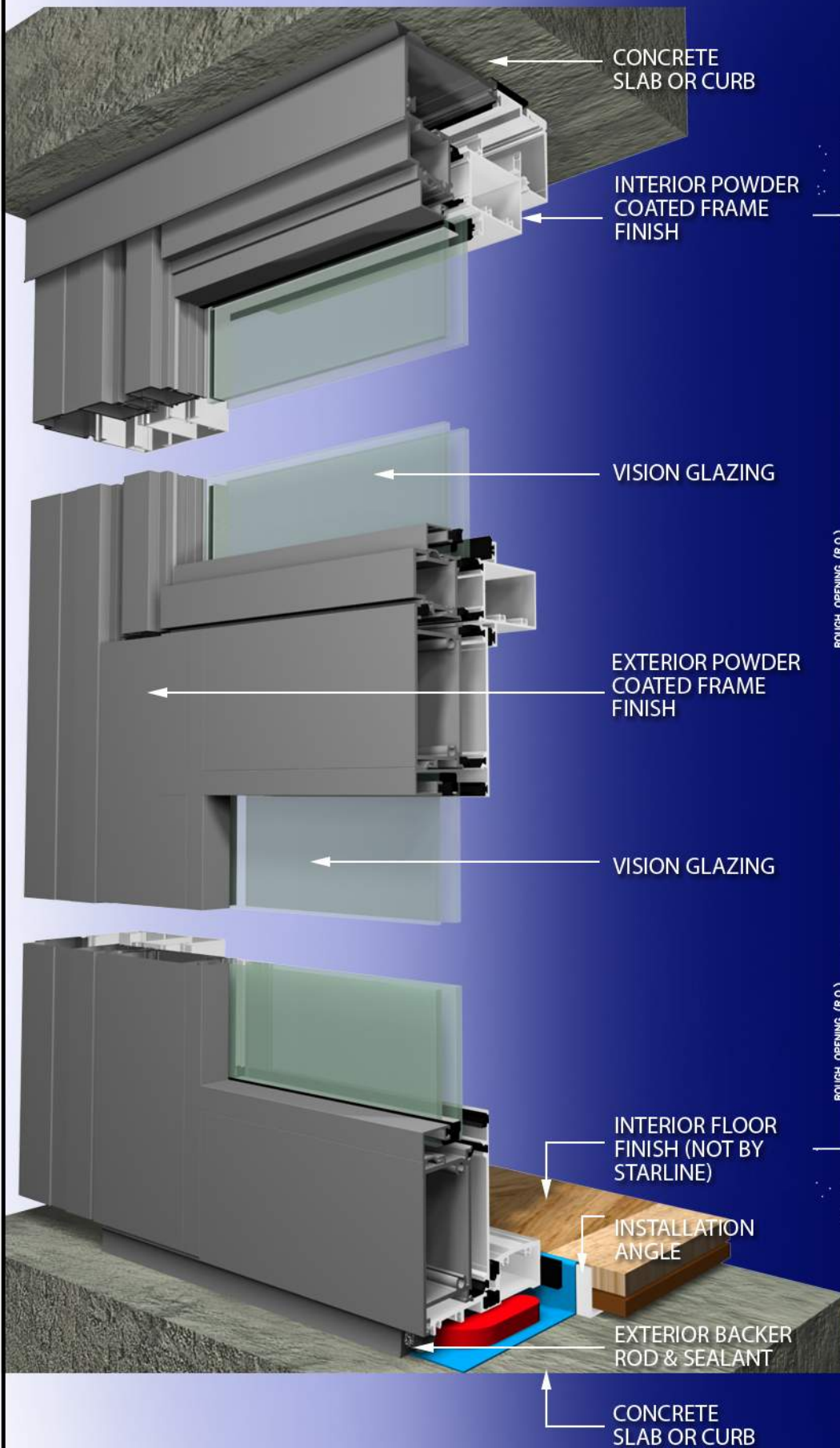

## SERIES 9502 - HEAD DEFLECTOR, TRANSOM & 1" STANDARD THRESHOLD

THIS DETAIL IS A SUGGESTED METHOD OF INSTALLATION AND DOES NOT REPRESENT A DETAIL THAT IS SUITABLE FOR A SPECIFIC PROJECT. TO CONFIRM PROJECT SPECIFIC DETAILS, PLEASE CHECK WITH YOUR WATERPROOFING/BUILDING ENVELOPE CONSULTANT.

**DRAWINGS ARE SUBJECT TO  
CHANGE WITHOUT NOTICE**

**AUTHOR:**

S.R.R.

**DATE:**

FEB. 2018

**DWG NO:**

9502 - DWG 1

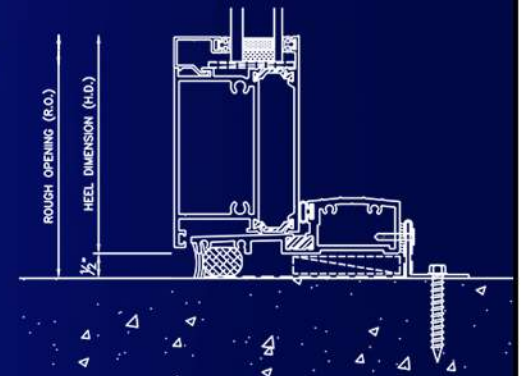
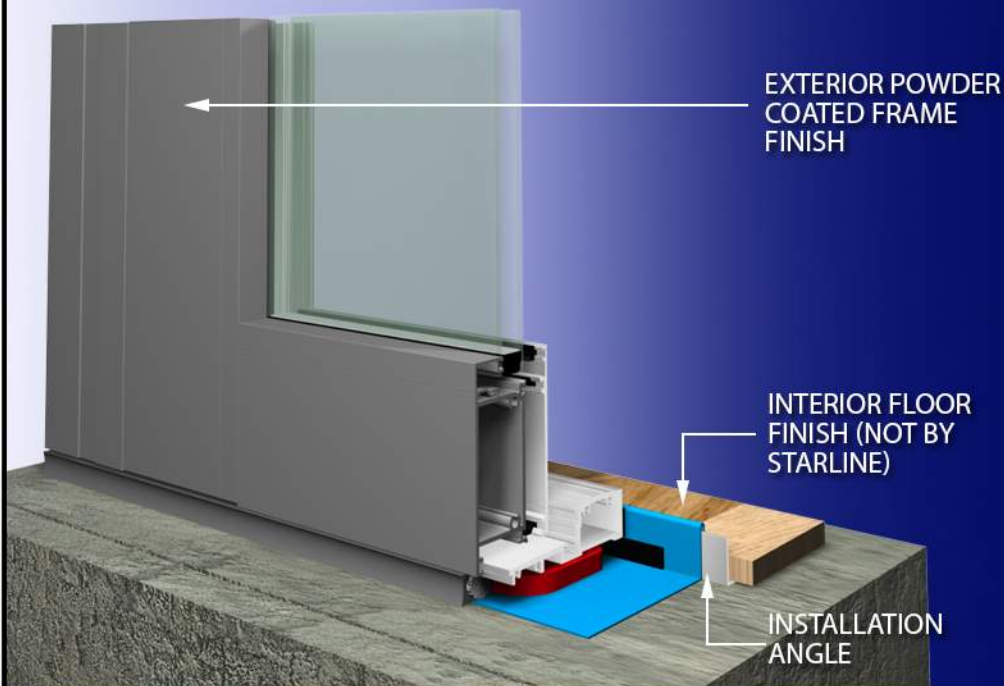
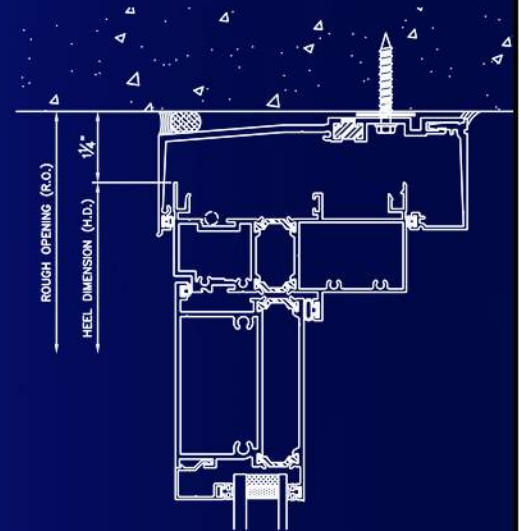
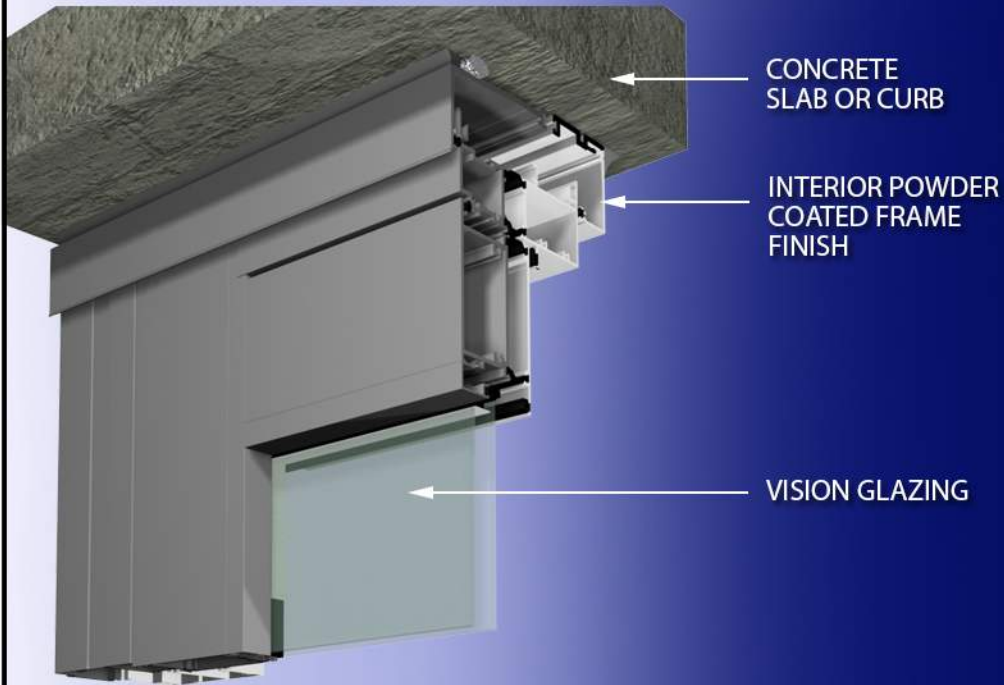

## SERIES 9502 - HEAD DEFLECTOR & 1" STANDARD THRESHOLD

THIS DETAIL IS A SUGGESTED METHOD OF INSTALLATION AND DOES NOT REPRESENT A DETAIL THAT IS SUITABLE FOR A SPECIFIC PROJECT. TO CONFIRM PROJECT SPECIFIC DETAILS, PLEASE CHECK WITH YOUR WATERPROOFING/BUILDING ENVELOPE CONSULTANT.

**DRAWINGS ARE SUBJECT TO  
CHANGE WITHOUT NOTICE**

**AUTHOR:**

S.R.R.

**DATE:**

APR. 2018

**DWG NO:**

9502 - DWG 2



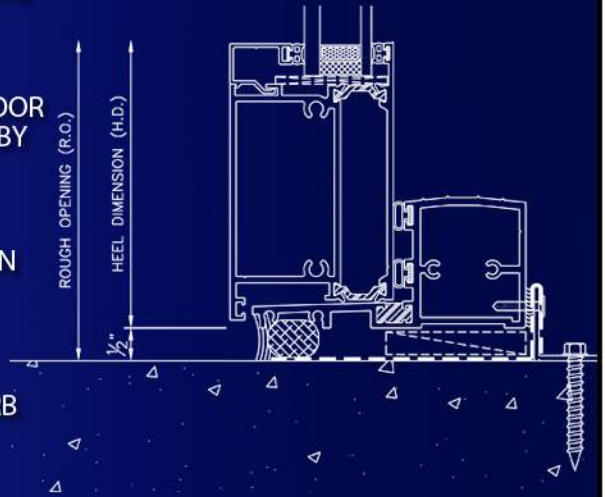
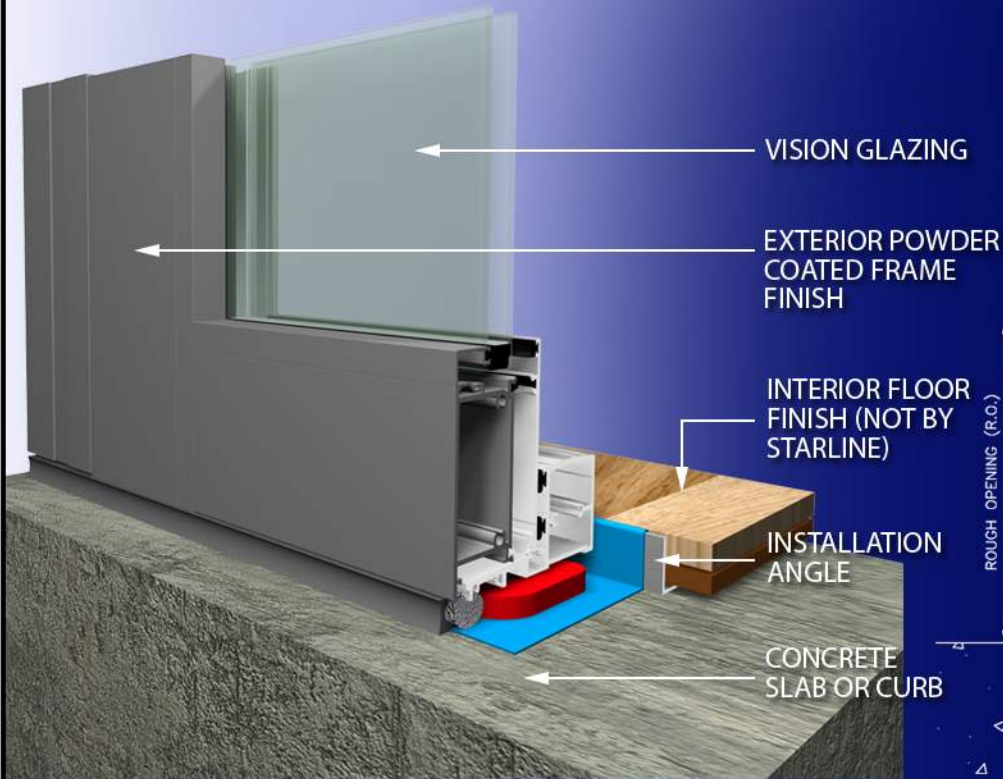

## SERIES 9502 - 2" THRESHOLD

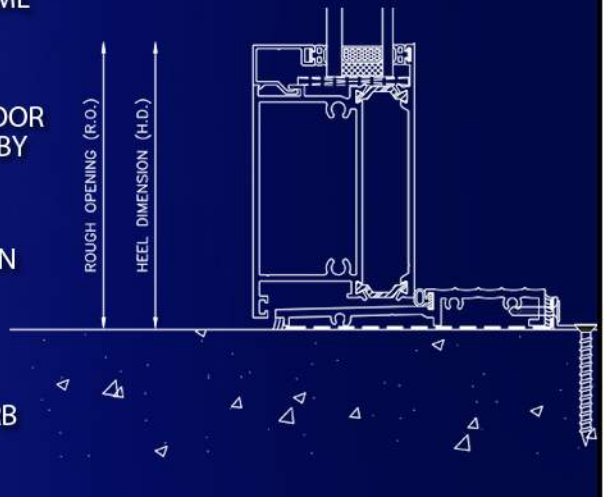
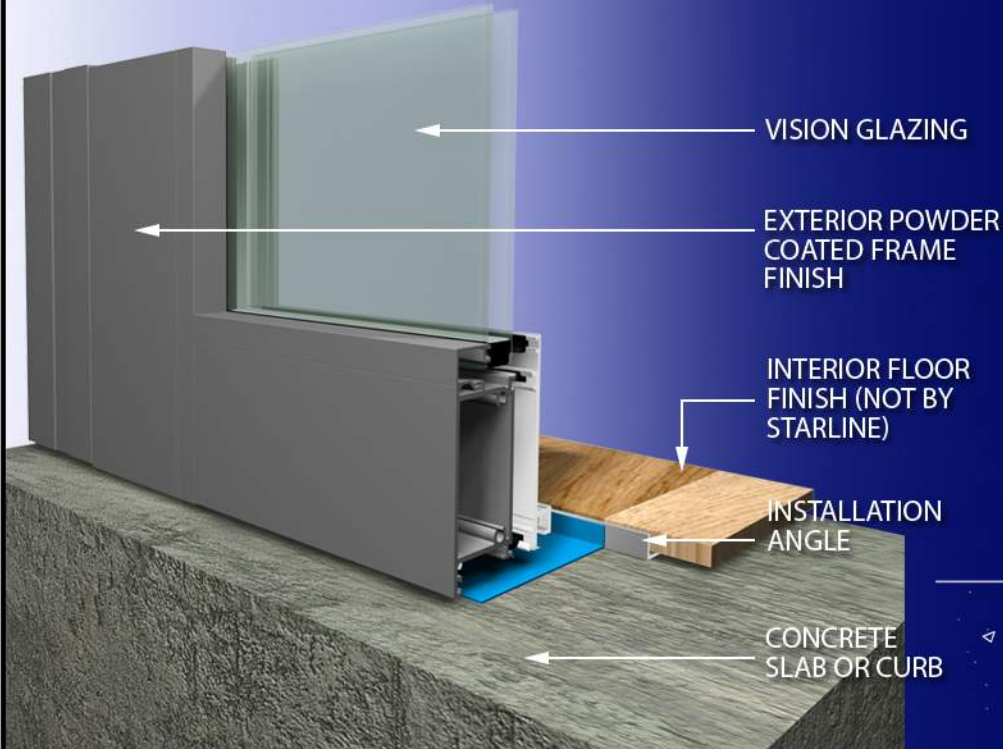

## SERIES 9502 - ACCESSIBLE (ADA) THRESHOLD

THIS DETAIL IS A SUGGESTED METHOD OF INSTALLATION AND DOES NOT REPRESENT A DETAIL THAT IS SUITABLE FOR A SPECIFIC PROJECT. TO CONFIRM PROJECT SPECIFIC DETAILS, PLEASE CHECK WITH YOUR WATERPROOFING/BUILDING ENVELOPE CONSULTANT.

**DRAWINGS ARE SUBJECT TO  
CHANGE WITHOUT NOTICE**

**AUTHOR:**

S.R.R.

**DATE:**

FEB. 2018

**DWG NO:**

9502 - DWG 3

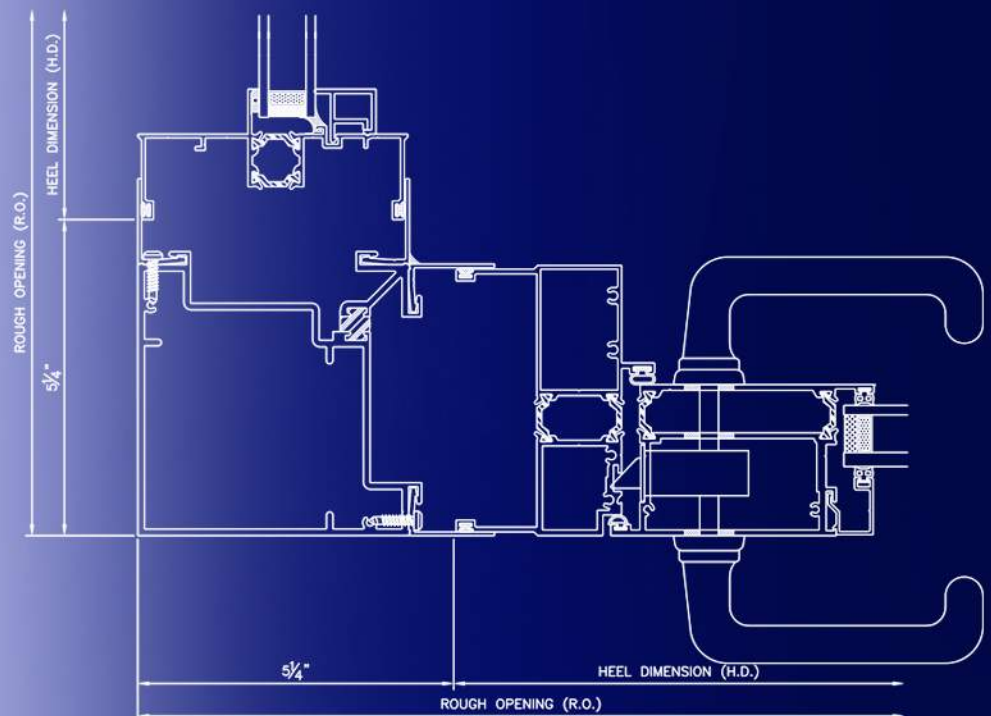
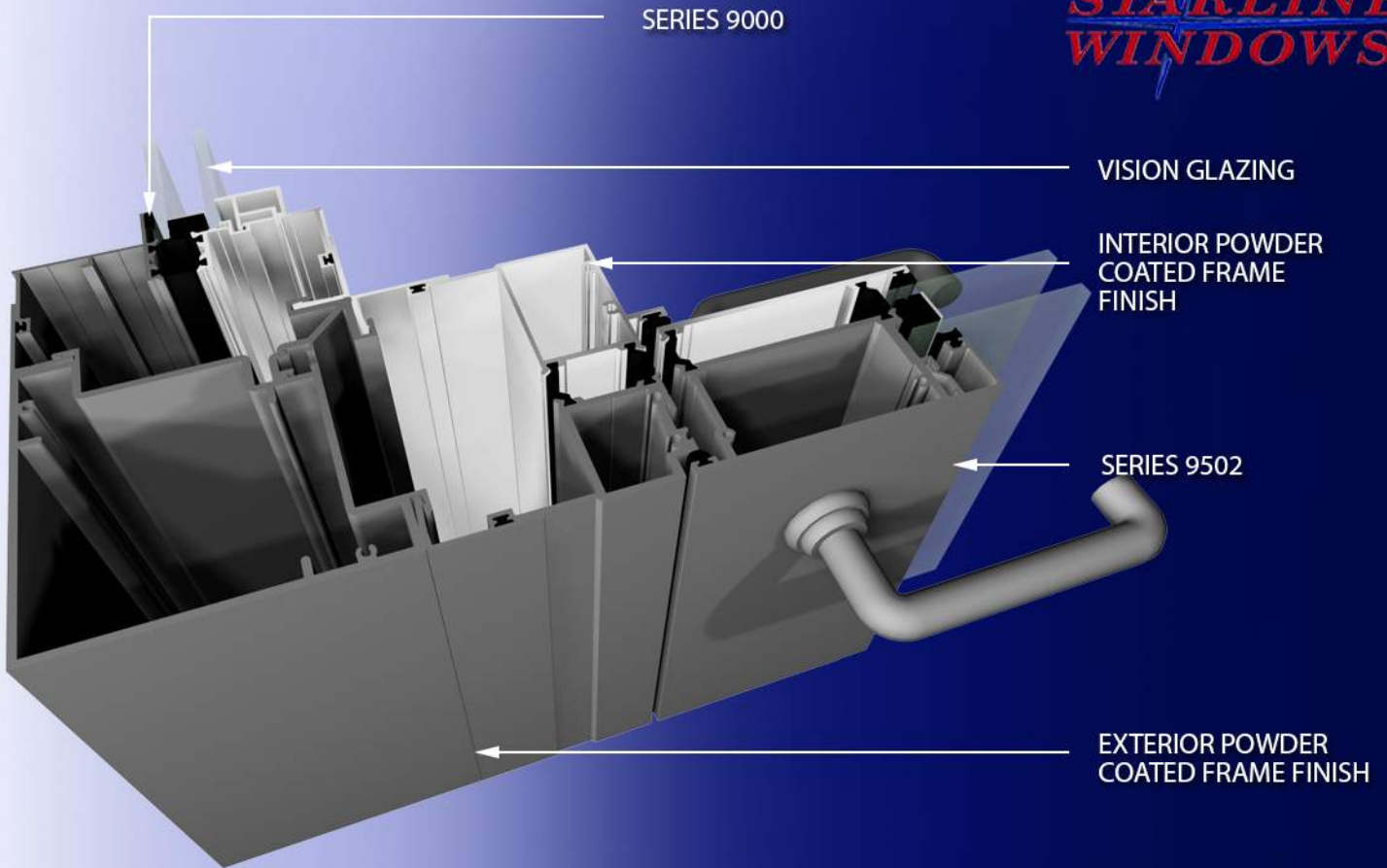

## SERIES 9502 - 90 DEGREE SEISMIC CORNER COUPLER

THIS DETAIL IS A SUGGESTED METHOD OF INSTALLATION AND DOES NOT REPRESENT A DETAIL THAT IS SUITABLE FOR A SPECIFIC PROJECT. TO CONFIRM PROJECT SPECIFIC DETAILS, PLEASE CHECK WITH YOUR WATERPROOFING/BUILDING ENVELOPE CONSULTANT.

**DRAWINGS ARE SUBJECT TO  
CHANGE WITHOUT NOTICE**

**AUTHOR:**

S.R.R.

**DATE:**

FEB. 2018

**DWG NO:**

9502 - DWG 4



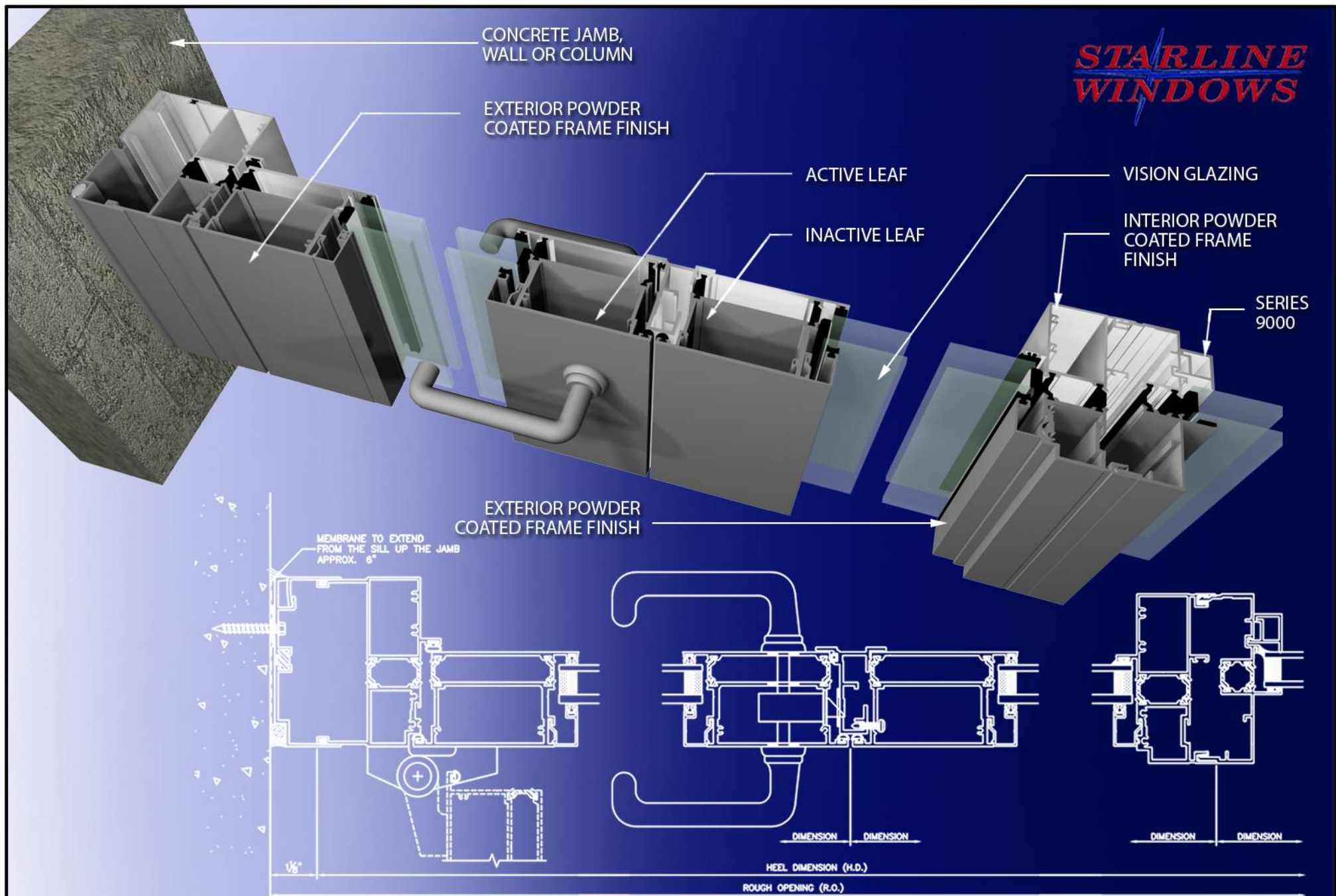

**SERIES 9502 - FRENCH DOOR - SEISMIC JAMB, ASTRAGAL & 180 DEGREE COUPLER**

THIS DETAIL IS A SUGGESTED METHOD OF INSTALLATION AND DOES NOT REPRESENT A DETAIL THAT IS SUITABLE FOR A SPECIFIC PROJECT. TO CONFIRM PROJECT SPECIFIC DETAILS, PLEASE CHECK WITH YOUR WATERPROOFING/BUILDING ENVELOPE CONSULTANT.

**DRAWINGS ARE SUBJECT TO  
CHANGE WITHOUT NOTICE**

**AUTHOR:**

S.R.R.

**DATE:**

FEB. 2018

**DRAWING NUMBER:**

9502 - DWG 5